

HOBART701 S Ridge Avenue, Troy, OH 45374
1-888-4HOBART • www.hobartcorp.com**HP2 SERIES
TWO WIDE PROOF BOX****HOBART****STANDARD FEATURES**

- Eye-level digital control panel mounted for easy access
 - Set heat/humidity system
 - Individual rack timers
- Easy access heat and humidity system
 - Internally mounted
 - Energy efficient
- Modular panel construction
- Cam lock attachment
- Stainless steel interior and exterior
- No flushing required – low maintenance
- Hydraulic door closure

OPTIONS

- Side trim
 - One side
 - Both sides
- Interior light
- Rear trim
- Stainless steel floor**
- Pass thru

MODEL CONFIGURATIONS

- 30" Interior Depth Two Door – Two Single Side or End Load Racks or One Double Rack (may be shipped assembled)**
- 50" Interior Depth Two Door – Three Single Side or End Load Racks or One Double Rack**
- 63" Interior Depth Two Door – Five Single End or Five Side Load Racks or Two Double Racks**
- 83" Interior Depth Two Door – Six Single End or Five Side Load Racks or Two Double Racks**
- 96" Interior Depth Two Door – Seven Single End or Five Side Load Racks or Two Double Racks**
- 116" Interior Depth Two Door – Nine Single End or Eight Side Load Racks or Three Double Racks**

Specifications, Details and Dimensions on Inside and Back.

Commonwealth of
Massachusetts
C1-05-05-20**HP2 SERIES TWO WIDE PROOF BOX**

HP2 SERIES TWO WIDE PROOF BOX



701 S Ridge Avenue, Troy, OH 45374
1-888-4HOBART • www.hobartcorp.com

FRONT VIEW

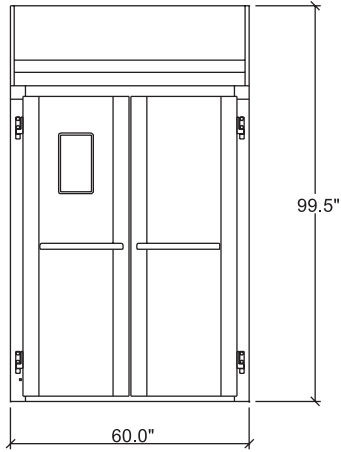

SIDE VIEW

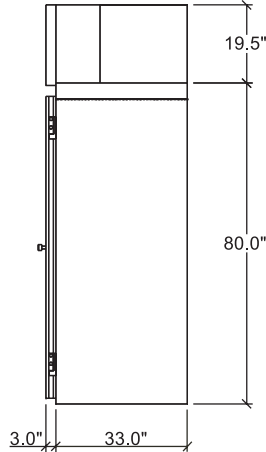

PLAN VIEW

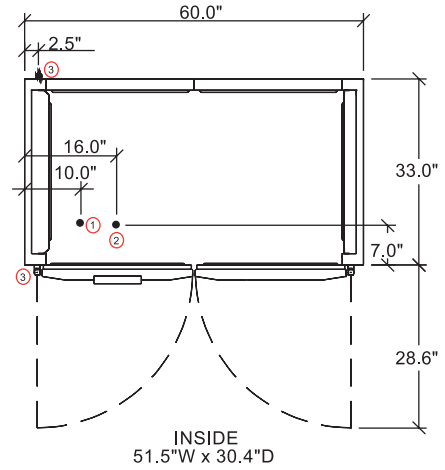

30" INTERIOR DEPTH

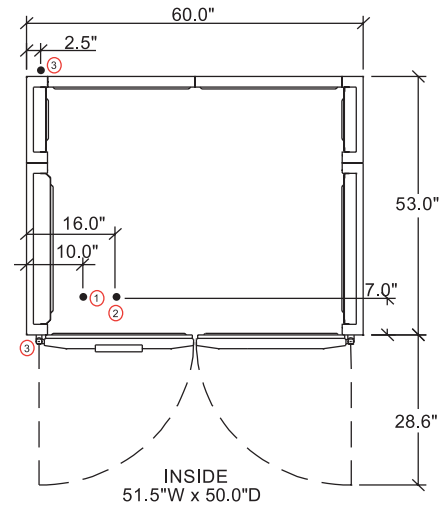
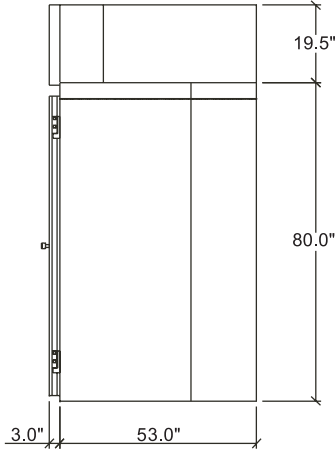
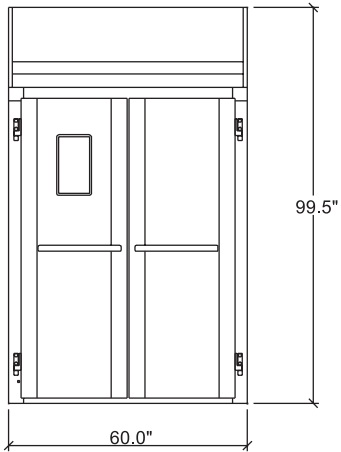

50" INTERIOR DEPTH

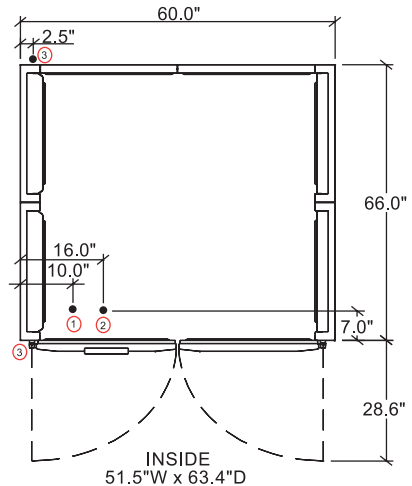
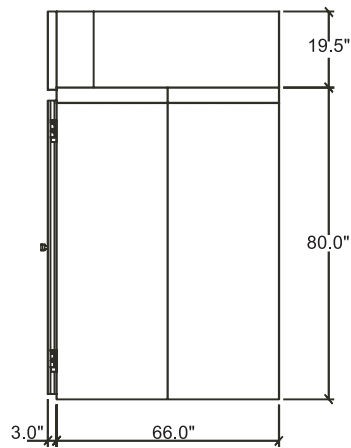
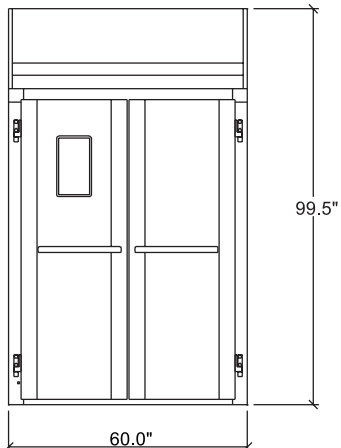

63" INTERIOR DEPTH

① Water AFF 87" ② Electrical AFF 87" ③ Drain AFF 5.5"



701 S Ridge Avenue, Troy, OH 45374
1-888-4HOBART • www.hobartcorp.com

HP2 SERIES TWO WIDE PROOF BOX

FRONT VIEW

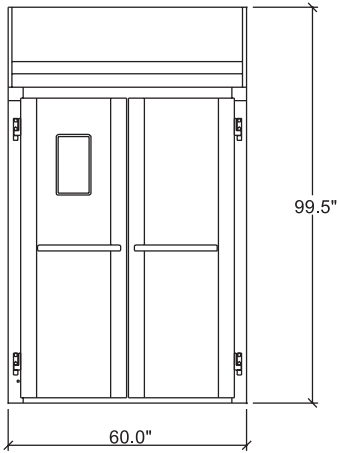

SIDE VIEW

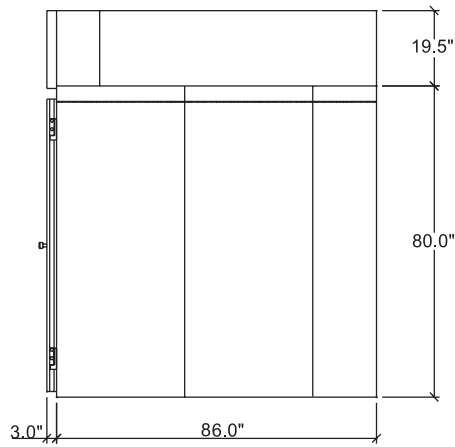

83" INTERIOR DEPTH

PLAN VIEW

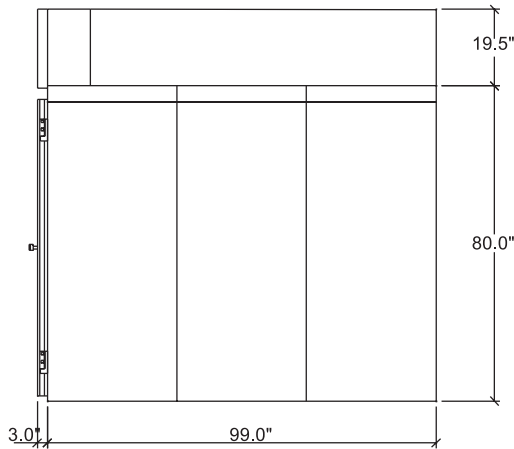
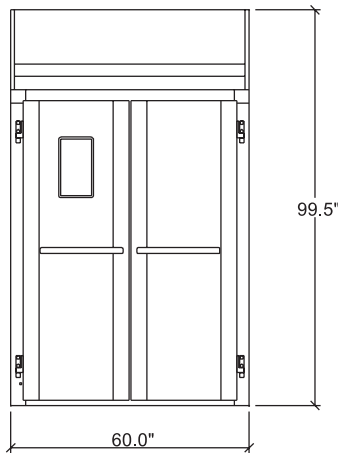
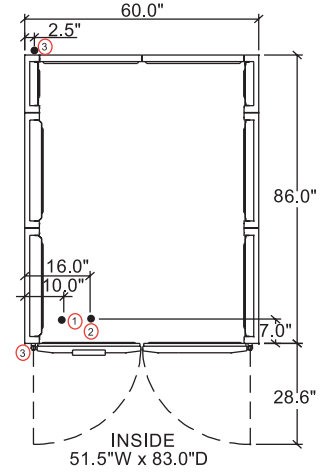

96" INTERIOR DEPTH

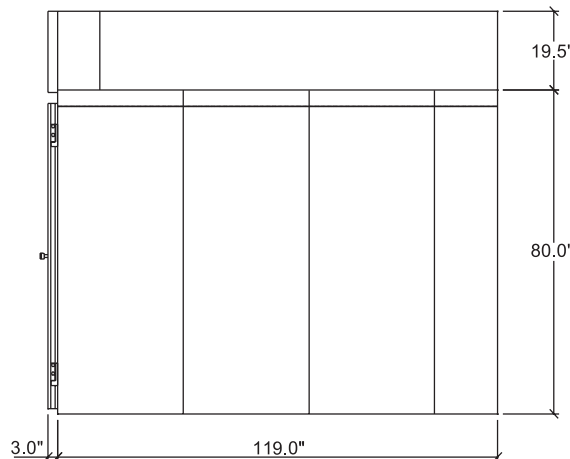
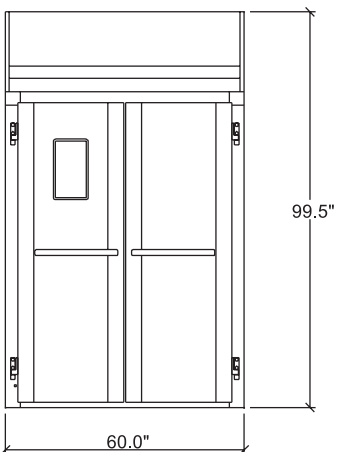
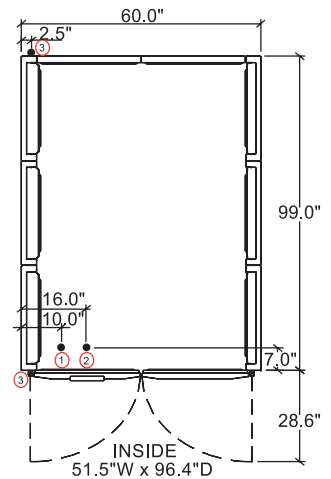

116" INTERIOR DEPTH

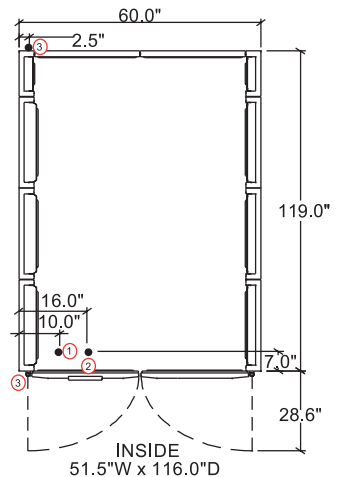

① Water AFF 87" ② Electrical AFF 87" ③ Drain AFF 5.5"

HP2 SERIES TWO WIDE PROOF BOX



701 S Ridge Avenue, Troy, OH 45374
1-888-4HOBART • www.hobartcorp.com

SPECIFICATIONS

GENERAL:

30" Interior Depth Two Door – Two Single Side or End Load Racks or One Double Rack (may be shipped assembled)

50" Interior Depth Two Door – Three Single Side or End Load Racks or One Double Rack

63" Interior Depth Two Door – Five Single End or Five Side Load Racks or Two Double Racks

83" Interior Depth Two Door – Six Single End or Five Side Load Racks or Two Double Racks

96" Interior Depth Two Door – Seven Single End or Five Side Load Racks or Two Double Racks

116" Interior Depth Two Door – Nine Single End or Eight Side Load Racks or Three Double Racks

CONSTRUCTION: Stainless steel interior and exterior is standard. The interior perimeter is supplied with bumpers on all sides to protect the finish.

CONTROLS: Eye-level digital controls for precise heat and humidity control. Temperature and humidity can be

set independently. Four individual count-down timers for products with different time requirements.

CAPACITY: Door opening will accommodate 75" high racks (standard), 72" high racks (pass thru).

HUMIDIFIER: Internally mounted, easy servicing. No flush cleaning required. Low maintenance spray mist system.

INSULATION: The proofer cabinet is rigid and formed of stainless steel panels with polyurethane foam insulation and sealed with gaskets to form a strong, energy efficient, tight and sanitary enclosure.

HARDWARE AND FITTINGS: Heavy-duty, plastic-coated door handles positioned horizontally. Positive action door closure.

FREIGHT CLASS: 85

For proper installation, floor should be level within 1/8" per foot not to exceed 3/4".

DETAILS AND DIMENSIONS

NOTE: Water supply must have the proper hardness, pH and chloride concentration. The recommended water hardness range is 2-4 grains per gallon. The recommended pH range is 7.0 to 8.0. The acceptable range for chloride concentration is 0-30 ppm. Consult your local water company and/or water conditioner dealer before installing the Proof Box.

PHYSICAL DATA	30" INTERIOR DEPTH	50" INTERIOR DEPTH	63" INTERIOR DEPTH
Interior Dimensions	75" H x 30" D x 51.5" W	75" H x 50" D x 51.5" W	75" H x 63" D x 51.5" W
Rack Capacity	2 single end, 2 side load or 1 double	3 single end, 3 side load, or 1 double	4 single end, 4 side load, or 2 double
Net Door Opening Height	75" STD / 72" Pass Thru	75" STD / 72" Pass Thru	75" STD / 72" Pass Thru
Net Door Opening Width	51.5"	51.5"	51.5"
Number of Doors	2	2	2
Exterior Dimensions	99.5" H x 36" D x 60" W	99.5" H x 56" D x 60" W	99.5" H x 69" D x 60" W
Power Input (w/neutral)*	208-240V/50-60Hz/1 18.4-20.4 A 208-240V/50-60Hz/3 18.4-20.4 A	208-240V/50-60Hz/1 18.4-20.4 A 208-240V/50-60Hz/3 18.4-20.4 A	208-240V/50-60Hz/1 37.0-42.0 A 208-240V/50-60Hz/3 32.0-37.0 A
Water Supply	1/2" FNPT @ 30-80 PSI	1/2" FNPT @ 30-80 PSI	1/2" FNPT @ 30-80 PSI
Drain	1/2" FNPT To Air Gap	1/2" FNPT To Air Gap	1/2" FNPT To Air Gap

PHYSICAL DATA	83" INTERIOR DEPTH	96" INTERIOR DEPTH	116" INTERIOR DEPTH
Interior Dimensions	75" H x 83" D x 51.5" W	75" H x 96" D x 51.5" W	75" H x 116" D x 51.5" W
Rack Capacity	6 single end, 5 side load, or 2 double	7 single end, 6 side load, or 3 double	9 single end, 8 side load, or 3 double
Net Door Opening Height	75" STD / 72" Pass Thru	75" STD / 72" Pass Thru	75" STD / 72" Pass Thru
Net Door Opening Width	51.5"	51.5"	51.5"
Number of Doors	2	2	2
Exterior Dimensions	99.5" H x 89" D x 60" W	99.5" H x 102" D x 60" W	99.5" H x 122" D x 60" W
Power Input (w/neutral)*	208-240V/50-60Hz/1 37.0-42.0 A 208-240V/50-60Hz/3 32.0-37.0 A	208-240V/50-60Hz/1 37.0-42.0 A 208-240V/50-60Hz/3 32.0-42.0 A	208-240V/50-60Hz/1 37.0-42.0 A 208-240V/50-60Hz/3 32.0-37.0 A
Water Supply	1/2" FNPT @ 30-80 PSI	1/2" FNPT @ 30-80 PSI	1/2" FNPT @ 30-80 PSI
Drain	1/2" FNPT To Air Gap	1/2" FNPT To Air Gap	1/2" FNPT To Air Gap

* Neutral wire circuitry needed to provide 110-120V for misc. control components. A separate line may be run or a transformer option will be required if 110-120V is not available. Consult factory for 110-120V requirements.

As continued product improvement is a policy of Hobart, specifications are subject to change without notice.